

# Swifty™

Lightning Fast USB Switch Interface

## Getting Started:

1. Using the Table select Swifty setting for your application – Mouse, Joystick or Keyboard.
2. Direct connect a single 3.5mm switch or use the available 2-to-1 adapter for two single switches. Direct connect a *dual switch*.
3. Plug Swifty into your host – PC, Mac, iPhone, iPad, Android phone or tablet, Chromebook, or communication device. *You may need a cable adapter.*
4. Use available Beam™ to wirelessly transmit up to three adaptive switch events to Swifty.

Switch 1	Switch 2	USB Device	Switch Event
ON	ON	Mouse	Left, Right Middle*
OFF	ON	Joystick	Btn1, Btn2, Btn3*
ON	OFF	Keyboard (iPad)	Enter, Space, Tab*
OFF	OFF	Keyboard	1,2,3*

Table 1: Settings (\* - For three switches use Beam)

Leave mode Switch 3 on.

Switch 4	Function
ON	Wireless IR Receiver ON
OFF	Wireless Receiver OFF

Both red and green status lights flash when your device recognizes Swifty. The red LED lights when a direct connect switch is actuated. The green LED lights when a wireless (using Beam) switch is actuated.

You may need an available USB adapter for your device: Lightning or USB-C for Apple and USB micro-B for others.

### Warranty:

A new Swifty is warranted against defects in material and workmanship for two (2) years from the date of shipment from Origin Instruments Corporation (OIC) or one of our dealers. See our full Swifty User Guide for additional warranty terms.

### FCC/CE:

Swifty complies with the limits for a Class B digital device, pursuant to Part 15 of the FCC Rules and similar rules for consumer IT equipment in the EU. These limits are designed to provide reasonable protection against harmful interference in a residential installation. Operation is subject to the following two conditions: (1) this device may

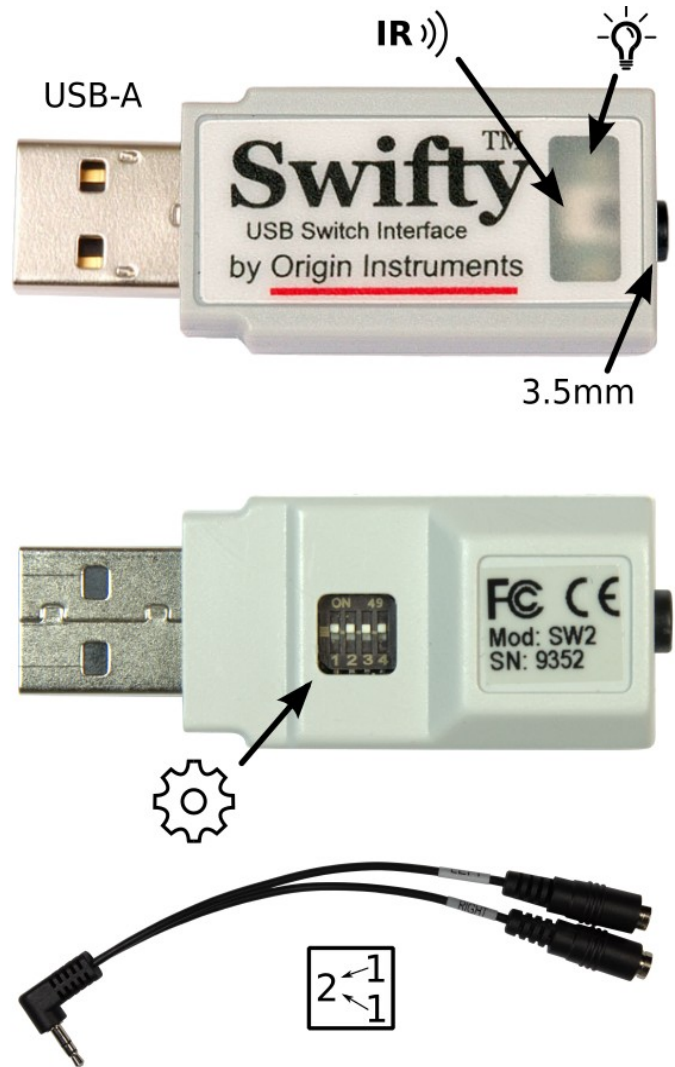

not cause harmful interference, and (2) this device must accept any interference received, including interference that may cause undesired operation.

### Disposal:

At end of life this device should be taken to a recycling center. The enclosure is ABS with a single electronic circuit board. Swifty should not be discarded in regular consumer waste. In some countries you may return the product to your retailer.

### Application Disclaimer:

Swifty shall not be used in an application where its failure would lead to injury or property loss.

